

# HAZARD MAPPING

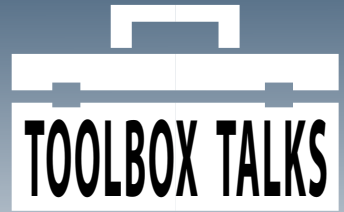

Mapping the hazards in your workplace can help you identify hazards and implement strategies to control them.



## TALK ABOUT IT

- How can you become familiar with your work site?
- How can mapping your worksite prevent injuries?

## FLOOR LAYER'S STORY

The floor layer crew is going to a new job site. The project is behind schedule and the floor layers need to complete the job in the next two weeks. This means plenty of overtime work. The carpenters and the electricians are completing work on another section of the building. Because it's a new job site and there are a lot of people working on site, the crew leader decides to use hazard mapping to identify hazards.

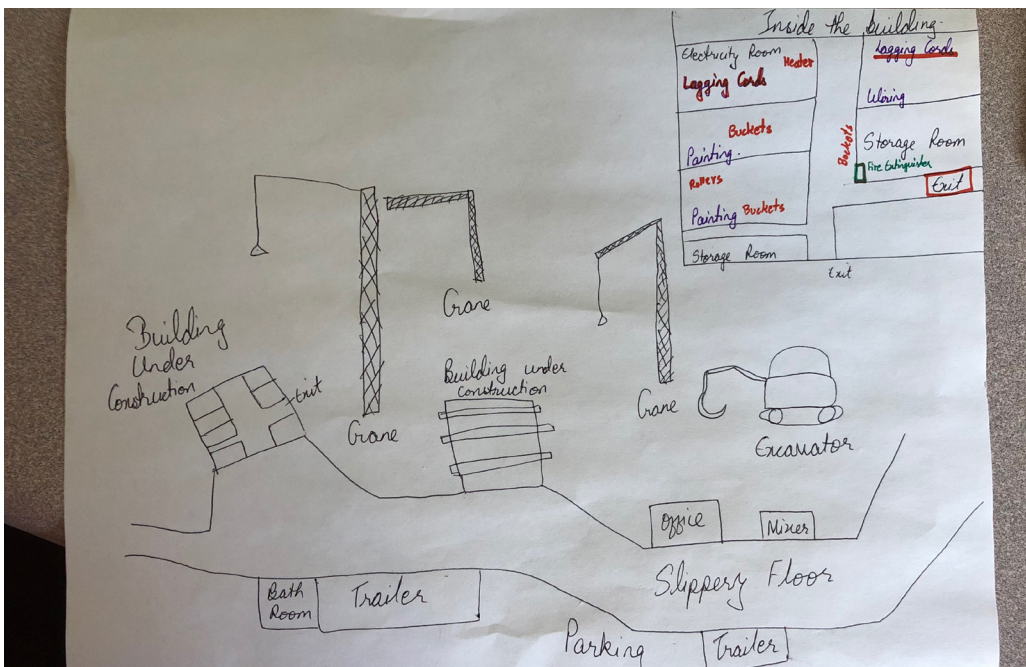

**HEALTHIER  
WORKFORCE  
CENTER.ORG**



# HAZARD MAPPING

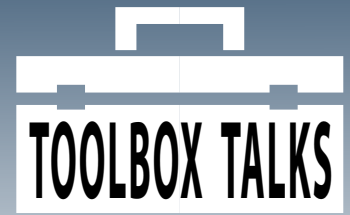

---

## **DRAW A HAZARD MAP OF YOUR WORKPLACE**

*Step 1:* Draw your workplace.

Include the equipment, doors, exits, hallways, etc.

*Step 2:* Label the hazards in your workplace.

Include safety and health-related hazards.

***Let's take a look at your drawings  
and discuss the different types of hazards  
and how to protect against or eliminate them.***

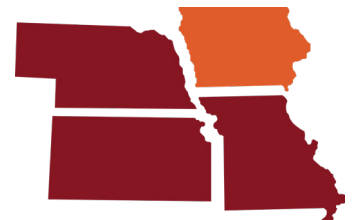

**HEALTHIER  
WORKFORCE  
CENTER.ORG**